



F. No. RW/NH-33044/05/2018/S&R (P&B)  
GOVERNMENT OF INDIA  
MINISTRY OF ROAD TRANSPORT & HIGHWAYS  
AN ISO 9001:2008 CERTIFIED MINISTRY  
S&R (P&B) ZONE

Transport Bhawan, 1, Parliament Street, New Delhi-110001.

18<sup>th</sup> January, 2018

**To**

1. The Chief Secretaries of all the State Governments/ UTs.
2. The Principal Secretaries/ Secretaries of all States/ UTs Public Works Department dealing with National Highways and Other Centrally Sponsored Schemes.
3. All Engineers-in-Chiefs and Chief Engineers of Public Works Department of States/ UTs dealing with National Highways and Other Centrally Sponsored Schemes.
4. The Director General (Border Roads), Seema Sadak Bhawan, Ring Road, New Delhi- 110 010.
5. The Chairman, National Highways Authority of India, G-5 & 6, Sector-10, Dwarka, New Delhi-110 075.
6. The Managing Director, NHIDCL, PTI Building, New Delhi-110001
7. All ROs and ELOs of the Ministry

**Subject: Providing Toilets Unit at all the Retail Outlets along  
National Highways-Reg- Swachha Bharat Mission**

**Sir,**

As per the Ministry's circular No. RW/NH-33023/19/99-DO-III dated 24.07.2013 on access permission to fuel station, private properties rest area complexes and such other facilities along National Highways, clause 4.1 inter-alia provides for toilet facilities.

2. It is seen that the toilets provided are small in size and could not cater for road users and are not demarcated separately for Gents & Ladies. It is also observed that the toilet units are not being maintained or in pathetic condition and are not accessible for all road users or kept under lock & key. In order to ensure that toilet units are provided in a uniform manner, a standard layout for toilet unit is enclosed herewith. The toilet unit is provided at a standalone location within the Retail Outlet premises duly equipped with lighting, water and requisite cleaning accessories etc. The necessary alterations in the case of existing Retail Outlets may be done as felt necessary in accordance with the standard layout. A separate access to all road users of the National Highways with traffic signages of the availability of toilet facility along National Highways may be provided and the toilets are kept open round the clock.

3. The toilet unit is to be provided at all fuel stations In this regard, all implementing agencies (State PWDs/NHAI/BRO/NHIDCL) are requested to ensure that all the fuel stations are equipped with toilet units within three months of the issue of this circular.

4. The field officials may report compliance to the Chief Engineer, Monitoring Zone of the Ministry for necessary action. The contents of this Circular may be brought to the notice of all concerned in your organization.

Yours faithfully,

Encl: As above



(Dr. Sanjay Wakchaure)  
Superintending Engineer, S&R (P&B)  
For Director General (Road Development) & SS

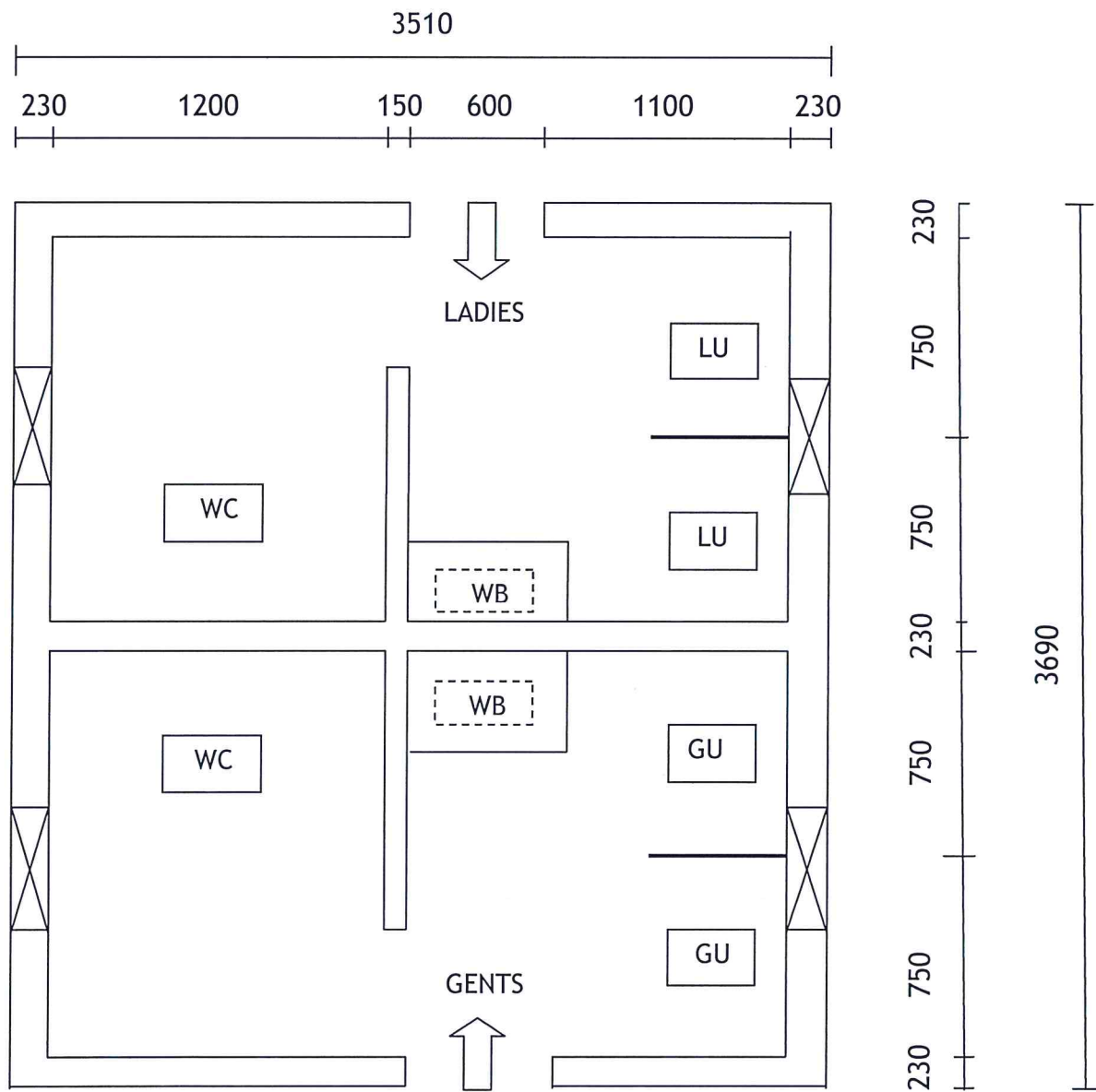

All dimensions are in mm

Legend:  
 WB: Wash Basin  
 WC: Water Closet  
 LU- Ladies Urinal  
 GU- Gents Urinal

## Toilet Layout Plan