



सत्यमेव जयते

भारत सरकार / GOVERNMENT OF INDIA

सड़क परिवहन राजमार्ग मन्त्रालय / Ministry of Road Transport & Highways
कार्यालय, मुख्य अभियन्ता-क्षेत्रीय अधिकारी / Office of the Chief Engineer-Regional
Officer

46/1, कैनाल रोड, जाखन, देहरादून-248 001/- 46/1, Canal Road, Jakhan,
Dehradun - 248 001

दूरभाष / Phone (0135) - 2531125

No. CE-RO/UK/NOC-OFC/2016-17/02

Dated: 12-04-2018

Invitation for Public Comments

SUB : Request for Proposal of Permission to lay optical fibre cable from km. 108.500 (Ghingarikhal) to Km. 171.00 (Pandwakhal) along NH-87E (new 109) total section length ROW applied for 62.500 Km. in state of Uttarakhand. - Reg.

M/s Reliance Jio Ltd vide letter no. 'Nil' dated 13.02.2018 submitted therewith a proposal mentioned under subject above for laying of OFC for consideration of this office.

2. Comments of public are invited on captioned draft proposal and the same should reach to below mentioned address till 11-05-2018, beyond which no comments will be considered.

The Chief Engineer-Regional Office,
Ministry of Road Transport & Highways
46/1, Canal Road, Jakhan
Dehradun-248001
(0135)-2738657
Mail ID : romorthddn@gmail.com

3. Letter dated 13.02.2018 from M/s Reliance Jio Ltd and cross-section are enclosed herewith for reference.

4. This is issued with the approval of Highways Administration, MoRTH, Dehradun.

Encl: As above

Yours Faithfully,

(Jagat Narayan)

Executive Engineer

For CE-Regional Officer Dehradun

To:-

1. The Senior Technical Director, NIC, Transport Bhawan, New Delhi-110001- for uploading on Ministry's website.



सत्यमेव जयते

भारत सरकार / GOVERNMENT OF INDIA

सड़क परिवहन राजमार्ग मन्त्रालय / Ministry of Road Transport & Highways
कार्यालय, मुख्य अभियन्ता-क्षेत्रीय अधिकारी / Office of the Chief Engineer-Regional
Officer

46/1, कैनाल रोड, जाखन, देहरादून-248 001/- 46/1, Canal Road, Jakhan,
Dehradun - 248 001

दूरभाष / Phone (0135) - 2531125

No. CE-RO/UK/NOC-OFC/2016-17/02

Dated: 14.03.2018

Invitation for Public Comments

SUB : Request for Proposal of Permission to lay optical fibre cable from km. 108.500 (Ghingarikhal) to Km. 171.00 (Pandwakhal) along NH-87E (new 109) total section length ROW applied for 62.500 Km. in state of Uttarakhand. - Reg.

M/s Reliance Jio Ltd vide letter no. 'Nil' dated 13.02.2018 submitted therewith a proposal mentioned under subject above for laying of OFC for consideration of this office.

2. Comments of public are invited on captioned draft proposal and the same should reach to below mentioned address till -04-2018, beyond which no comments will be considered.

**The Chief Engineer-Regional Office,
Ministry of Road Transport & Highways
46/1, Canal Road, Jakhan
Dehradun-248001
(0135)-2738657
Mail ID : romorthddn@gmail.com**

3. Letter dated 13.02.2018 from M/s Reliance Jio Ltd and cross-section are enclosed herewith for reference.

4. This is issued with the approval of Highways Administration, MoRTH, Dehradun.

Encl: As above

Yours Faithfully,

**(Jagat Narayan)
Executive Engineer
For CE-Regional Officer Dehradun**

To:-

1. The Senior Technical Director, NIC, Transport Bhawan, New Delhi-110001- for uploading on Ministry's website.

To,

The Regional Officer

13 Feb. 18

Ministry of Road Transport & Highways

Canal Road,

Dehradun (U.K.)

Sub:- Ref. Proposal of permission to lay optical fibre cable from Km. 108.500 to Km 171.000 along NH-87E(new 109) Total section length Row applied for 62.5 kms in state of Uttarakhand.

Sir,

Reference to your letter no. RO/UK/NOC – OFC/2016 -17/02 dated November 28,2017. The Point wise reply to the observations is as follows:

- License fee Rs . 14,68,849/- will be submit as per MoRTH Guideline within week.
- Regarding Performance Bank Guarantee (BG NO. 0541BGR0235518 DATED 12-12-2017) Rs.100 per mtr has been submitted in favour of Chief Engineer- Regional Officer, Ministry of Road Transport & Highways, Dehradun as per circular.
- Strip plan/Route Plan/Duct Diagram showing the OFC, Chainage , Width of ROW cable from the edge of ROW etc. attached as per MoRTH guideline.
- Each page of instant proposal signed.

The instant proposal is re-submitted for consideration after making rectification based upon your observations.

You are requested to grant us the permission at the earliest.

Yours Sincerely,

RELIANCE JIO INFOCOMM LTD.
NCR Plaza New Cantt Road
Dehradun - 248001

Capt. Rahul Verma

State coordinating Officer –UK

Reliance Jio Infocomm Ltd.



For further communication please contact (Capt. Rahul Verma-9557826644) C/O. RJIL, S-14,15,16 2nd floor, NCR Plaza New Cantt. Road, Hathibadkala, Dehradun, Uttarakhand, India Email – rahul.d.verma@ril.com

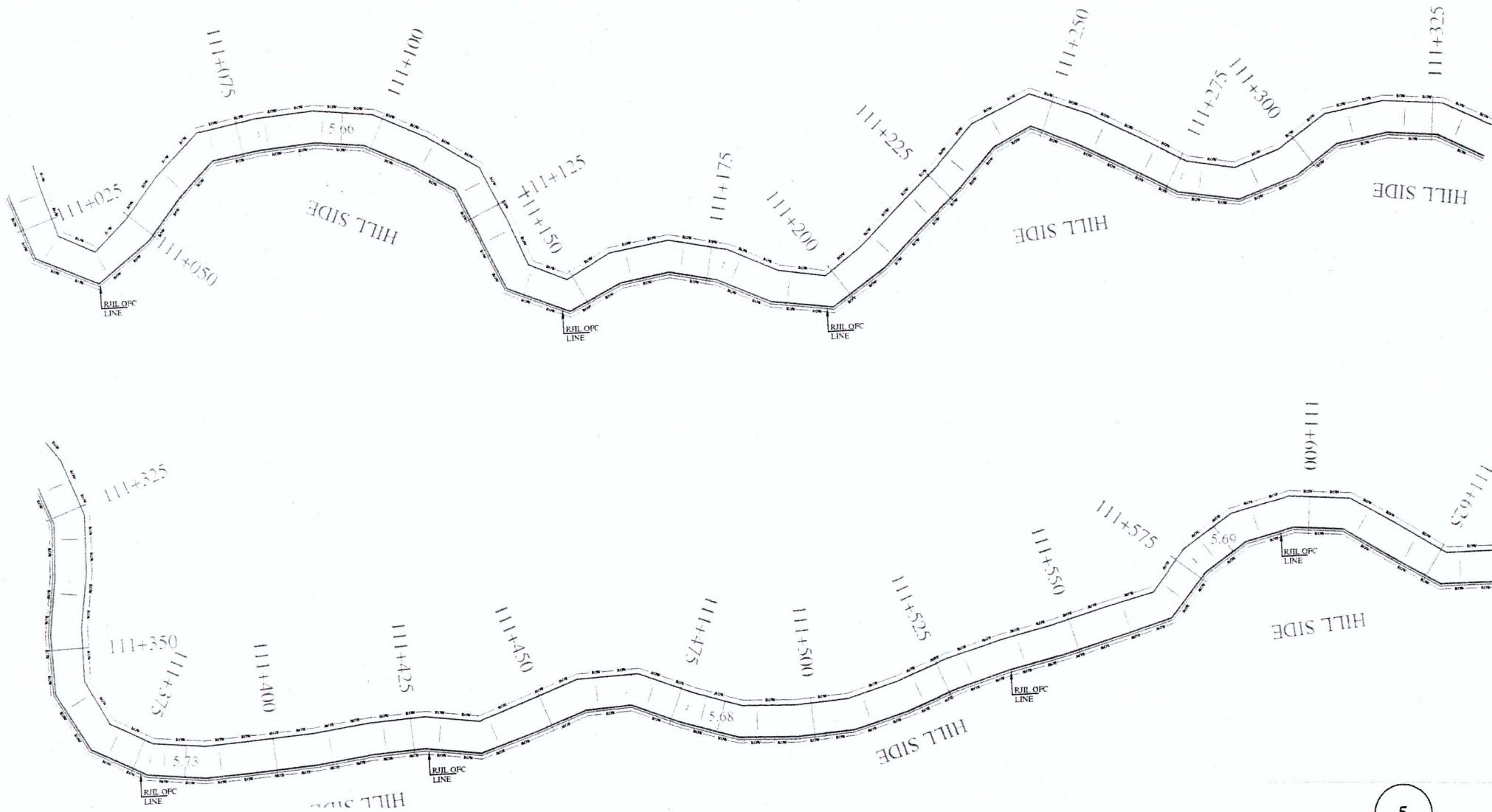

5

CLIENT:-

RELIANCE JIO INFOCOMM LIMITED

TITLE:

STRIP PLAN OF GHINGARIKHAL TO PANDAWAKHAL MOTOR ROAD NH 87E (NEW NH 109) FOR LAYING OFC

NOTE :-

1. ALL DIMENSIONS, LEVELS AND CHANGES ARE IN METERS.

OFC LINE

ROAD

CENTER LINE

HOUSE

CENTER LINE

CONSULTANTS:-

TECHNICAL CONSULTANCY SERVICES

REGD. OFF. 14-C ARAWALI ENCLAVE,

GMS ROAD DEHRADUN.

TEL. NO. : 0135-2720017, 2107754

e-mail : tcsdoon@yahoo.com

e-mail : tcsdoon@gmail.com

Chainage = 170+900

Level Datum = 1224.000

Design LEVELS	1354.050	1354.063	1354.110	1354.063	1354.050
Design OFFSET	-2.375	-1.875	-0.000	1.875	2.375
Design WIDTH	0.500	1.875	1.875	0.500	

Chainage = 171+100

Level Datum = 1214.000

Design LEVELS	1366.677	1366.689	1366.736	1366.689	1366.677
Design OFFSET	-2.375	-1.875	-0.000	1.875	2.375
Design WIDTH	0.500	1.875	1.875	0.500	

Chainage = 171+300

Level Datum = 1202.000

Design LEVELS	1337.054	1337.869	1337.882	1337.929	1337.882	1337.869
Design OFFSET	-4.000	-2.375	-1.875	0.000	1.875	2.375
Design WIDTH	95.427	0.500	1.875	1.875	0.500	

BED FILL (GRANULAR MATERIAL LUMPS, COLDS AND CABBLES)

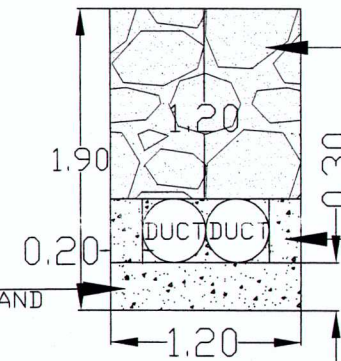

OVER FILL (GRANULAR MATERIAL IN LAYERS NOT GREATER THEN 15CM. IN EACH LAYER)

SIDE FILL (GRANULAR MATERIAL IN LAYERS NOT GREATER THEN 15CM. IN EACH LAYER)

RELIANCE JIO INFODMM LTD
NOR Pata New Pata Road
Dehradun - 248001

CLINT:-
EX.Engineer
RELIANCE JIO
INFODMM LIMITED

NAME OF ROAD :- X-SECTION OF
GHINGARIKHAL TO PANDAWAKHAL MOTOR ROAD
NH 87E(NEW NH 109) FOR LAYING OFC

CHAINAGE :-
IN K.M. 170+900 TO 171+300 K.M.

X-Section

SCALE :- H = 1:100
V = 1:100

SURVEYED &
DESIGNER BY:-
TECHNICAL CONSULTANCY SERVICES
Regd off 14-C,ARAWALI ENCLAVE, GMS ROAD DEHRADUN
PH: 0135- 3251869, 9837043174, 9997093344+
E-Mail: tcsdoon1@rediffmail.com/tcsdoon@yahoo.com

J.E

A.E

E.E

84

SHEET.NO