

No.RO/VJA/Misc-24C/WS/NH-216/ 2607

Government of India

Ministry of Road Transport & Highways

Regional Office, Vijayawada

Door No.38-2-3/2, Gorledalapanna Veedhi, Near American Hospital, Punnammithota Vijayawada-520010. Tele: 0866-2970220 ; Fax: 0866-2571985

Invitation of Public Comments

**Sub: Proposal of M/s.GGPL for access permission to CNG fuel station at Km101/295-318.20 (RHS) of NH-216 at Survey No.312/2A in Amalapuram Town in East Godavari district in the state of Andhra Pradesh - Public Comments - Reg.**

The Deputy General Manager, M/s Godavari Gas Private Limited, Rajamahendravaram has submitted a proposal seeking access permission to CNG fuel station at Km101/295-318.20 (RHS) of NH-216 at Survey No.312/2A in Amalapuram Town in East Godavari district in the state of Andhra Pradesh

2. As per the Ministry circular issued vide OM No.RW/NH/33023/19/99-DO.III dated 16.03.2016, the Highway Administration will put the proposal in Ministry's website seeking claims/objections from public (on grounds of public inconvenience, safety and general public interest) for a duration of 60days.

3. In view of the above, the comments from public on the above mentioned proposal is invited on the address mentioned below.

**Address:** The Regional Officer  
Ministry of Road Transport & Highways  
Regional Office, Vijayawada  
Door No.38-2-3/2, Gorledalapanna Veedhi,  
Near American Hospital, Punnammithota, Vijayawada-520010.  
Tele: 0866-2970220 ; Fax: 0866-2571985  
Email: romorthvijayawada@gmail.com

4. This issues with the concurrence of the Highway Administration cum Regional Officer, MoRTH, Vijayawada.

Yours faithfully,

Encl: As above



(B. Sai Sreenivas)  
Asst. Executive Engineer  
Regional Office, Vijayawada.

Copy to:-

1. Senior Technical Director, NIC, Transport Bhawan, New Delhi-110001 for uploading on Ministry's website.
2. The Deputy General Manager, M/s GGPL, Rajamahendravaram for information.

**FORM-A**

Form for inviting public comments on the application for relaxation in the guidelines/norms for access permission to fuel stations, private properties, rest areas complexes and other such facilities along National Highways

**Sub: Proposal of M/s.GGPL for access permission to CNG fuel station at Km101/295-318.20 (RHS) of NH-216 at Survey No.312/2A in Amalapuram Town in East Godavari district in the state of Andhra Pradesh - Public Comments - Reg.**

The comments by the general public needs to be given within 60days of uploading the online application for comments

Sl.No.	Item	Details
1	Name of the person who is desiring to give comments	
2	Address of the person	
3	Details of the application for access permission against which comments are being given (name of applicant and other details like site address etc.)	
	a) Application No.	
	b) Name of applicant (who applied to access permission)	
	c) Details of application	
4	Whether the specific permission if given, shall cause any damage to Highways? If yes, please give details.	
5	Whether specific permission if given, shall adversely affect safety and convenience of the traffic on the Highways? If yes, please give the details.	
6	Whether specific permission if given, shall adversely affect hygiene or cause nuisance and pollution the Highways? If yes, please give the details.	

**CHECK LIST**

(Enclosure to Ministry of Road Transport &amp; Highways letter No RW/NH-33023/19/99-DO III dated 24.07.2013)

**Check list for getting approval for installation of new Fuel Stations along National Highways**

- 1.0 **General information**
- 1.1 National Highway Number : NH-214(OLD NH-214)
- 1.2 State : ANDHRA PRADESH
- 1.3 Location : PERURU (AMALAPURAM TOWN LIMITS)
- 1.3.1 (Chainage in km) : 101/295-318.20
- 1.3.2 [Side of the NH(Left or Right side of NH towards increasing chainage/Km/direction)] : RHS
- 1.4 Name of Highway Authority : RO, MORTH  
(NHAI/PWD/BRO)
- 1.5 Highway Administration Address : The Regional Officer  
Ministry of Road Transport Highways  
Near American Hospital  
Punnammathota, Vijayawada - 520010
- 1.6 Name of Oil Company (as applicable) : GODAVARI GAS PRIVATE LIMITED  
Name and address of Owner of Retail Outlet/Private Property: : DY.GENERAL MANAGER (CNG)  
OFFICE : 85-6-23/2, 2ND FLOOR, NEAR MORAMPUDI JUNCTION,  
RTC COMPLEX ROAD, RAJAHMUNDRY-533107, ANDHRA PRADESH.

**Stipulated Norms for Fuel Stations (To be updated on revision of IRC:12)**

Sl.No.	Item	Measurement at site	MORTH Norms	Whether complying with MORTH Norms* *
1	Distance from Intersections			
	<b>1.1 Non-Urban (Rural) Stretch.</b>			
	<b>1.1.1 Plain and Rolling Terrian</b>			
	i) Intersection with NHs/SHs/MDRs/City Roads	NA	1000m	
	ii) Intersection with Rural Roads/approach roads to private and public properties.	NA	300m	
	<b>1.1.2 Hilly/Mountainous Terrian</b>			
	i) Intersection with NHs/SHs/MDRs.	NA	300m	
	ii) Intersection with all other roads and tracks	NA	100m	
	<b>1.2 Urban Stretches</b>			
	1.2.1 Plain and Rolling Terrain	NA		
	<b>(a) Urban Area with population of more than 20,000 and less than one Lakh</b>			
	i) Intersection with any category of roads of carriageway width of 3.5m and above	565M	300m	YES
	ii) Intersection with roads of carriageway width of less than 3.5m	181M	100m	YES
	<b>(b) Urban Area with population of one Lakh and above</b>			
	iii) Intersection with any category of road (irrespective of carriageway width)	NA	100m	
	<b>1.2.2 Hilly and Mountains Terrian</b>			
	i) Intersection with any category of road (irrespective of carriageway width)	NA	100m	
2	Gap in the central median from fuel station (for Divided Carriageway only)	NA	300m	



Sl.No.	Item	Measurement at site	MORTH Norms	Whether complying with MORTH Norms* *
15	Radius of Turning curve	13.0m	Minimum 13m	YES
16	Radius of Non-Turning curve	3.0m	Minimum 1.5m Maximum 3m	YES
	(i) Whether additional land acquisition is required beyond by the side ROW (to provide prescribed turning radius) by the owner of the fuel station.	NA		
	(ii) If Yes, mention the additional L.A. required to be done by the owner of the fuel station.	NA	(Mention Area (Sq.m.))	
	(iii) Whether additional land acquisition as above is required by the side of ROW (to provide prescribed turning radius) as been done by the owner of the fuel station.	NA		
	(iv) If Yes, whether the documentary evidence of the L.A. details are attached.	NA		
17	Minimum downward slope of access roads towards the fuel station.	2.0%	Minimum 2%	YES
18	Difference in level between the highway and the fuel station and access area measured at the edge of the shoulder on the highway.	300mm	Minimum 300mm	YES
19	Provision of Culvert, designed for drainage according to IRC:SP-13	RCC Slab culvert of 1.0M span (IRC:SP-13)	Slab culvert with iron grating of adequate strength	YES
20	(i) Provision of drinking water and toilet facilities along with proper display board at the entry to the fuel station (ii) Provision of proper drainage arrangement for fuel station premises	Provided	Drawing showing these arrangements as per satisfaction of highway authorities to be submitted	YES
21	Provision of adequate sign and markings as per the drawings.	YES	Minimum requirement as shown in the drawing	YES
22	Whether the oil company has certified that the fuel station is neither in operation nor energized and that construction of the fuel station has not been commenced.	YES	-	YES

It is certified that the fuel station is neither in operation nor energized and that construction of the fuel station has not been commenced. Further, we bear full responsibility for genuineness of the site particulars mentioned above and for adherence to the stipulated norms.



[Name, Designation and Signature of the authorised representative of the concerned Oil Company

Note:- If norms are not satisfied, detailed explanation needs to be given, otherwise the application will not be considered. In all cases supporting documents as per Annexure-I have to be submitted, otherwise the case will be summarily rejected.

*The Right Of Way (ROW) of the National Highway available at the proposed location from the centre line of the nearest carriageway is [ 17.40m ]*

*The above particulars along with the drawings and documents have been verified and are certified as correct as per the prevailing site conditions.*



[Name, Designation and Signature of the concerned field authority of NHA/State PWD/BRO]

Description	Chainage	Chainage	Distance in metres
>3.5M INTERSECTION	101.295	100.730	565M
<3.5M INTERSECTION	101.295	101.114	181M
FUEL STATION	109.315	101.318	7997M

LOCATION:  
 SURVEY No.:312/2A  
 VILLAGE :PERURU  
 (AMALAPURAM TOWN LIMITS)  
 Mandal :AMALAPURAM  
 DISTRICT :EAST GODAVARI  
 STATE :ANDHRA PRADESH  
 ON :NH-216(OLD NH-214)  
 CHAINAGE:101/295-318.20  
 (KATHIPUDI-DIGAMARRU SECTION)

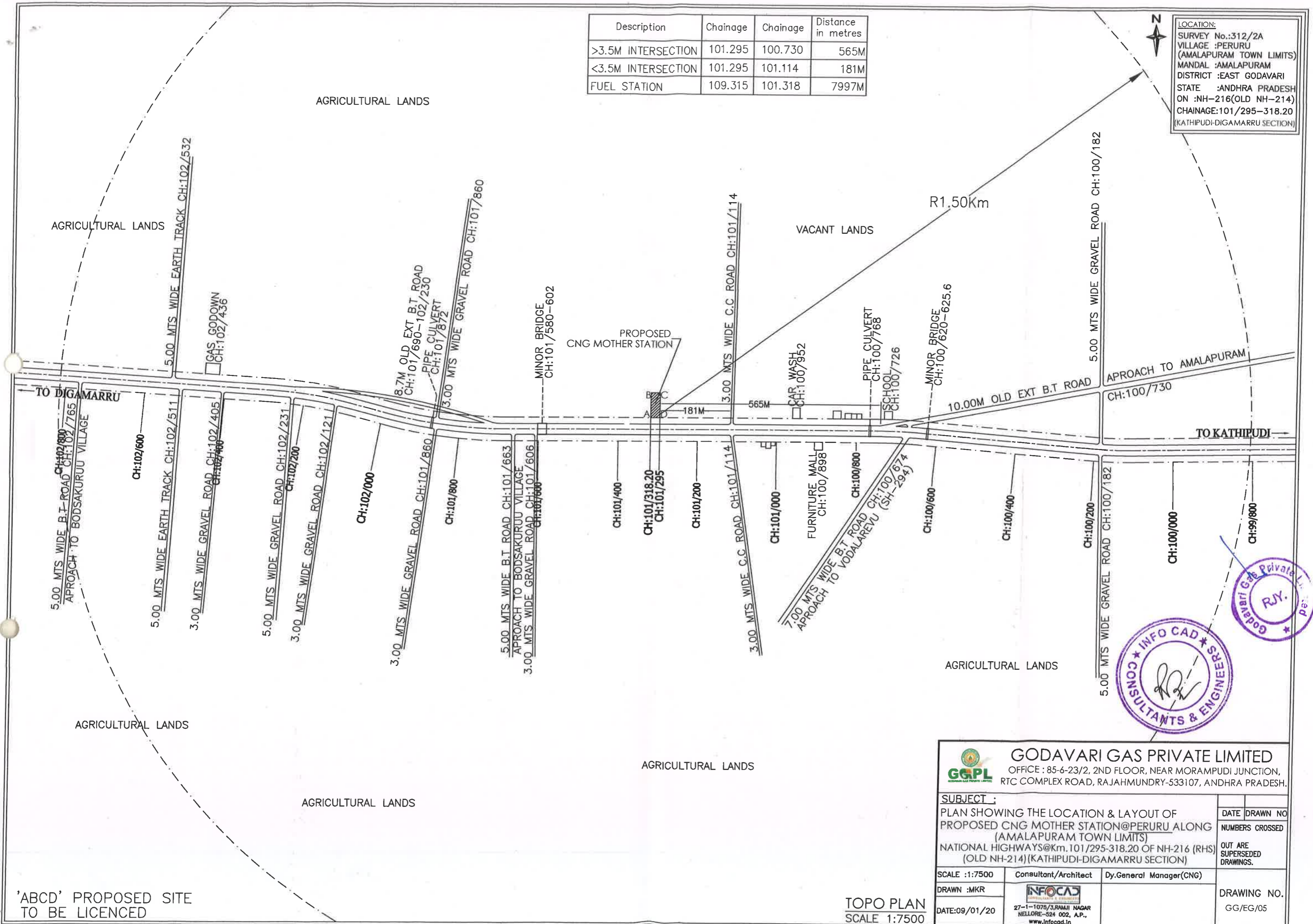

'ABCD' PROPOSED SITE TO BE LICENCED

TOPO PLAN  
 SCALE 1:7500



**GODAVARI GAS PRIVATE LIMITED**  
 OFFICE : 85-6-23/2, 2ND FLOOR, NEAR MORAMPUDI JUNCTION,  
 RTC COMPLEX ROAD, RAJAHMUNDRY-533107, ANDHRA PRADESH.

**SUBJECT :**  
 PLAN SHOWING THE LOCATION & LAYOUT OF PROPOSED CNG MOTHER STATION@PERURU ALONG (AMALAPURAM TOWN LIMITS) NATIONAL HIGHWAYS@Km.101/295-318.20 OF NH-216 (RHS) (OLD NH-214)(KATHIPUDI-DIGAMARRU SECTION)

SCALE :1:7500	Consultant/Architect	Dy.General Manager(CNG)
DRAWN :MKR	 27-1-1075/3,RAMJI NAGAR NELLORE-524 002, A.P., www.infocad.in	
DATE:09/01/20		

DATE	DRAWN NO
NUMBERS CROSSED	OUT ARE SUPERSEDED DRAWINGS.
DRAWING NO. GG/EG/05	